

REF	PART NO	DESCRIPTION	QTY	LIST PRICE
NO			REQ	
1	0-04954-4	RECEIVER M-PIPE	4230	1 2.36
2	0-04130-1	MOUTHPIPE NICKL	4230	1 8.16
3	0-03441-3	HOOK FINGER SUP	X2XX	1 1.30
4	0-04628-4	W-KEY ASSM MP L	X2XX	1 1.42
5	0-04560-9	SPRING WATERKEY	XXXX	2 .17
6	0-04462-8	SCREW W-KEY LAQ	XXXX	2 .11
7	0-04685-4	BRIDGE WKEY 3SL	X2XX	2 .81
8	0-00170-1	CORK W-KEY 312D	XXXX	2 .02
9	0-04452-9	NIP WK TRB MILL	XXXX	1 .07
10	0-05972-5	TUBE OS SL TUN	4230	2 .96
12	0-05971-7	TUBE 15 SL TUN	X2XX	2 .58
13	0-03954-5	FERR 3/8 SLIDE	42XX	2 .16
14	0-04800-9	CROOK TUN SL NI	4230	1 2.60
15	0-03280-5	CROOK RWSHRN BR	X2XX	1 3.17
17	0-31400-5	PSTN ASM 1 NIPL	42XX	1 13.13
18	0-31401-3	PSTN ASM 2 NIPL	42XX	1 12.71
19	0-31402-1	PSTN ASM 3 NIPL	42XX	1 12.70
20	0-03994-1	GUIDE STAR	OLDS	3 .32
21	0-04124-4	RING SPRNG SEAT	OLDS	3 .17
22	0-04111-1	SPRING VAL OLDS	4XXX	3 .05
23	0-03912-3	STEM PSTN OLDSBR4	XXXX	3 .93
24	0-05743-0	CORK PSTN STEM	4XXX	3 .13
25	0-03380-3	FELT PSTN STM GR	OLD	3 .01
26	0-03184-9	CAP TOP LAQ OP	4X30	3 1.32
27	0-03381-1	FELT TOP CAP GR	OLDS	3 .05
28	0-03432-2	FNGRTIP ASSM LQ	4130	3 .91
29	0-03185-6	CAP BOT LAQ OP	4X30	3 .83
30	0-05870-1	TUBE OS SL 3	4130-42	2 .96
31	0-03124-5	BRC ASM SLIDE	42XX	3 .87
32	0-03060-1	POST ASM 3 M/P	4230	2 .59
33	0-03070-0	SOC ASSM 3 M/P	4230	1 1.11
35	0-05865-1	TUBE 15 SL 3RD	X2XX	2 .69
36	0-05869-3	TUBE OS SL 3	4130-42	2 .68
37	0-05980-7	CRK 1 3 COR SL	X2XX	2 1.04
38	0-04450-3	NIP WK 3SL MILL	XXXX	1 .07
39	0-04625-0	W-KEY ASSM 3 LQ	XXXX	1 1.44
40	0-04850-4	LYREHLDR ASM BR	4XXX	1 1.22
41	0-03081-7	SCREW LAQ SET	OLDS	1 .25
42	0-04833-0	PSH ROD ASM LAQ	4X00	1 1.18
43	0-04011-3	SLIDE 2 OSS COR	N 42	2 .29
45	0-04001-4	SL 2SL INS C NI	4XXX	2 .39
46	0-05082-3	CROOK 2 COR SL	42XX	1 1.04
47	0-03630-1	KNOB ASM SL PRL	4XXX	1 .71
48	0-03093-2	BRC ASM 3 TUN	41XX	2 .71
49	0-05868-5	TUBE OS 1ST	4130-42	2 .68
51	0-05864-4	TUBE 15 1ST	4130-42	2 .46
52	0-03384-5	RING SL BUMPER	O-R	2 .10
53	0-03950-3	FERR 1/4 SLIDE	4XXX	2 .13
54	0-05340-5	STUD 1 SL PIVOT	4XXX	1 .19
55	0-05342-1	SCREW STUD LAQ	4X25	2 .17
56	0-05351-2	PIVOT YOKE DRLL	XXXX	1 .43
57	0-05350-4	BAR THD 1 SL TR	4125	1 1.01
58	0-05352-0	YOKE HINGE SLTED4	XXXX	1 .80
59	0-05321-5	BRDG ASSEM 1 SL	4XXX	1 2.37
60	0-05323-1	SCRW BRG 1SL TRG4	X25	1 .63
61	0-05332-2	SPRING 1 SL TRG	4X25	1 .44
62	0-05436-1	LEV ASM 1ST SL	L4230	1 6.82
63	0-03100-5	BRC ASM 1 TUN	4230	1 1.04
64	0-04291-1	BRC ASSEM#1 BEV	4X20	2 .97
65	0-03272-2	ROD CUNN NS	4X10-30	1 .13
66	0-05130-0	BRC ASM 2 BAL B	4XXX	2 .67
67	0-05040-1	BRC ASM 6 BAL B	41XX	2 .67
68	0-19256-7	BELL ENGR 4007	4230	1 89.87
69	0-03970-1	RING SL BEAD TC	4XXX	4 .11
A	0-31323-9	1ST SL ASSY	4230 LQ	1 10.17
B	0-31311-4	TUN SL ASSY	4230 LQ	1 24.30
C	0-31274-4	2ND SL ASSY	4130-42	1 5.39
D	0-31273-6	3RD SL ASSY	4130-42	1 24.30
J	0-21331-4	M-PIPE ASY W/KEY	4230	1 12.08
K	0-21236-5	WKEY KIT 3SL	4130-42	1 2.57
L	0-21239-9	WKEY KIT M-PIPE	4230	1 2.55
M	0-21294-4	TRIG KIT 1ST SL	4230	1 12.87

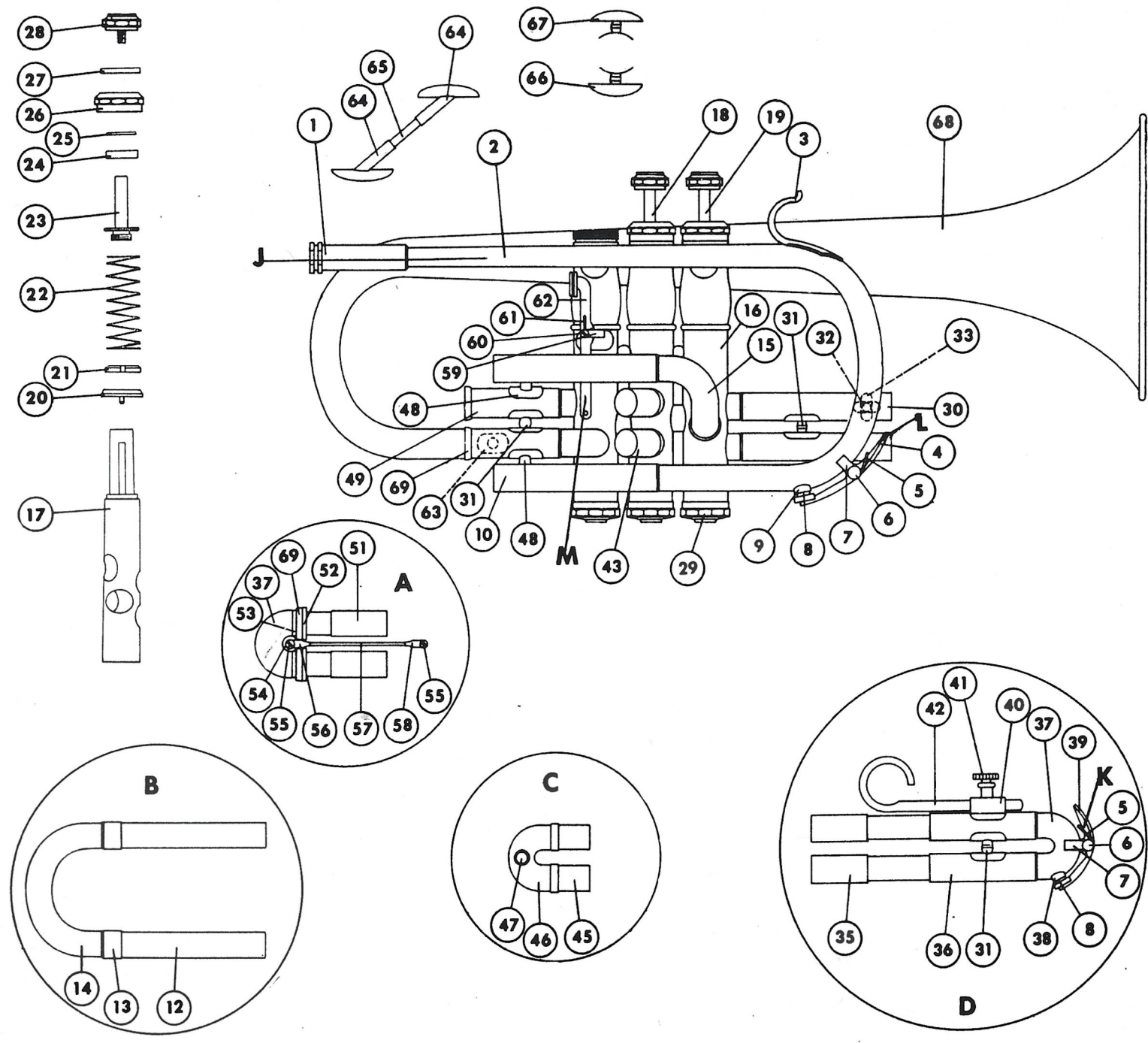

4230 0-5 OPERA CORNET