

REF NO	PART NO	DESCRIPTION	QTY REQ	LIST PRICE
1	0-04950-2	RECEIVER M-PIPE 4210	1	2.85
2	0-03441-3	HOOK FINGER SUP 2XX2	1	1.30
3	0-04143-4	MOUTHPIPE BRASS 4210	1	8.06
4	0-04685-4	BRIDGE WKEY 3SL 2XX2	2	.81
5	0-04560-9	SPRING WATERKEY XXXX	2	.17
6	0-04638-3	W-KEY ASM NI-PL 4210	1	2.54
7	0-04463-6	SCR WKEY NI-PLT 4X10	2	.12
8	0-04454-5	NIP WK TUN M/P XXXX	1	.08
9	0-00180-0	CORK W-KEY 360D XXXX	2	.03
10	0-05979-0	TUBE IS SL TUN 4210	1	.46
11	0-05926-1	TUBE OS 3 4137-4210	1	.74
12	0-03467-8	BRACE U VALVE 4210	1	.77
14	0-05933-7	TUBE IS SL TUN 4210	1	.58
15	0-03941-2	FERR 3/8 SLIDE 4100	1	.16
16	0-15310-6	CRK 1 SL VAL BR X500	1	2.19
17	0-03954-5	FERR 3/8 SLIDE 42XX	1	.16
18	0-05975-8	TUBE IS SL TUN 4210	1	.58
19	0-05978-2	TUBE OS SL TUN 4210	1	.74
20	0-05976-6	TUBE IS SL TUN 4210	1	.35
21	0-03281-3	CROOK RMSHRN ST 4210	1	3.71
22	0-05491-6	VALVE ASSM 4210	1	47.53
23	0-31187-8	PSTN ASM 1 NIPL 4XXX	1	12.92
24	0-31188-6	PSTN ASM 2 NIPL 4XXX	1	12.50
25	0-31403-9	PSTN ASM 3 NIPL 4210	1	12.72
26	0-03994-1	GUIDE STAR OLDS	3	.32
27	0-04124-4	RING SPRNG SEAT OLDS	3	.17
28	0-04111-1	SPRING VAL OLDS 4XXX	3	.05
29	0-03911-5	STEM PSTN NPL O 4XXX	3	.76
30	0-05743-0	CORK PSTN STEM 4XXX	3	.13
31	0-03380-3	FELT PSTN STM GR OLD	3	.01
32	0-03188-0	CAP TOP NI-PLT 4X10	3	1.12
33	0-03381-1	FELT TOP CAP GR OLDS	3	.05
34	0-03433-0	FNGRTP ASM NPL 4X10	3	.93
35	0-03177-3	CAP BOT NI-PLT 4X10	3	.83
36	0-05977-4	TUBE OS SL 3RD 4210	2	.59
37	0-04401-6	BRC GUIDE COR 42XX	1	.76
39	0-05941-0	TUBE OS SL 3 4210-00	2	.49
40	0-05080-7	CRK 1 3 COR SL 2XX2	2	1.04
41	0-05974-1	TUBE IS SL 3 X210-20	1	.69
42	0-08194-3	SCREW LOCK LAO 4X10	1	.86
43	0-04380-2	BRC ASM LOCK 4205-10	1	1.81
44	0-04850-4	LYREHLDR ASM BR 4XXX	1	1.22
45	0-03085-8	SCR SET NI-PL O 4XXX	1	.26
46	0-04835-5	PSH ROD ASM NPL 4X10	1	2.09
47	0-04412-3	SCREW STOP 3 SL 4XXX	1	.08
48	0-04411-5	BAR 3 SL TUN 4X05-10	1	.96
49	0-04626-8	W-KEY ASSM 3N-P XXXX	1	2.22
50	0-04450-3	NIP WK 3SL MILL XXXX	1	.07
51	0-04010-5	SLIDE 2 OSS COR B 42	2	.21
53	0-04000-6	SL 2SL INS C BR 420X	2	.25
54	0-05082-3	CROOK 2 COR SL 42XX	1	1.04
55	0-03632-7	KNOB SLIDE BR 4XXX	1	.07
56	0-05940-2	TUBE OS 1ST 4210-00	2	.49
57	0-03124-5	BRC ASM SLIDE 42XX	1	.87
59	0-05937-8	TUBE IS 1ST X1XX-X2	2	.46
60	0-03956-0	FERR 3/8 SL A5 42XX	2	.17
61	0-05340-5	STUD 1 SL PIVOT 4XXX	1	.19
62	0-05343-9	SCR STUD NIPLT 4X10	2	.17
63	0-05351-2	PIVOT YOKE DRLL XXXX	1	.43
64	0-04350-5	BAR THD 1 SL TR 4210	1	.40
65	0-05352-0	YOKE HINGE SLTED4XX	1	.80
66	0-03384-5	RING SL BUMPER O-R	2	.10
67	0-03132-8	BRC ASM BELL 4XXX	1	.80
68	0-03930-5	FERR BL CON L5 4205	1	1.44
69	0-03272-2	ROD CONN N5 4X10-30	1	.13
70	0-04291-1	BRC ASSEM#1 BEV 4XXO	2	.97
71	0-05130-0	BRC ASM 2 BAL B 4XXX	2	.67
72	0-05040-1	BRC ASM 6 BAL B 41XX	2	.67
73	0-19252-6	BELL ENGR 4003 4210	1	34.51
74	0-04360-4	BRDGE 1 SL TRIG 4X10	1	1.39
75	0-05190-4	SCRW BRG 3SL TRG4XXX	1	1.10
76	0-04420-6	SPRING 1 LEVER 4X10	1	.27
77	0-04340-6	LEV ASM 1 SL NP 4110	1	5.22
78	0-03970-1	RING SL BEAD TC 4XXX	4	.11
A	0-31312-2	1ST SL ASSY 4210 N5	1	8.04
B	0-31309-8	TUN SL ASSY 4210 N5	1	11.77
C	0-31303-1	2ND SL ASSY 4200-10	1	5.26
D	0-31310-6	3RD SL ASSY 4210 N5	1	18.85
J	0-21324-9	M-PIPE ASY W/KEY4210	1	15.91
K	0-21234-0	WKEY KIT 3SL 4110-42	1	3.37
L	0-21238-1	WKEY KIT M-PIPE 4210	1	3.70
M	0-21288-6	TRIG KIT 1ST SL 4X10	1	9.97

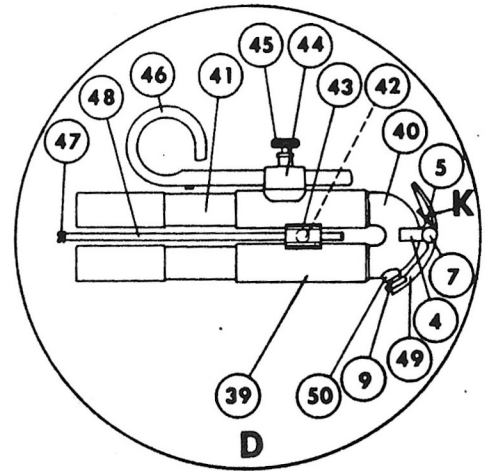
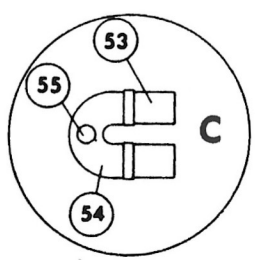
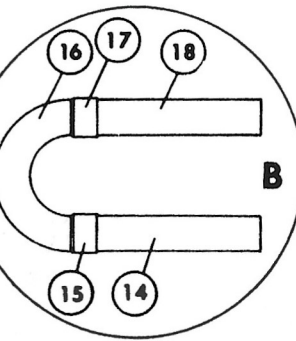
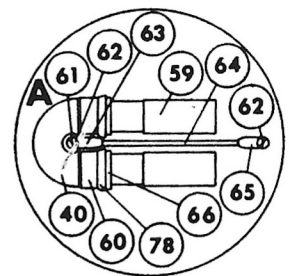
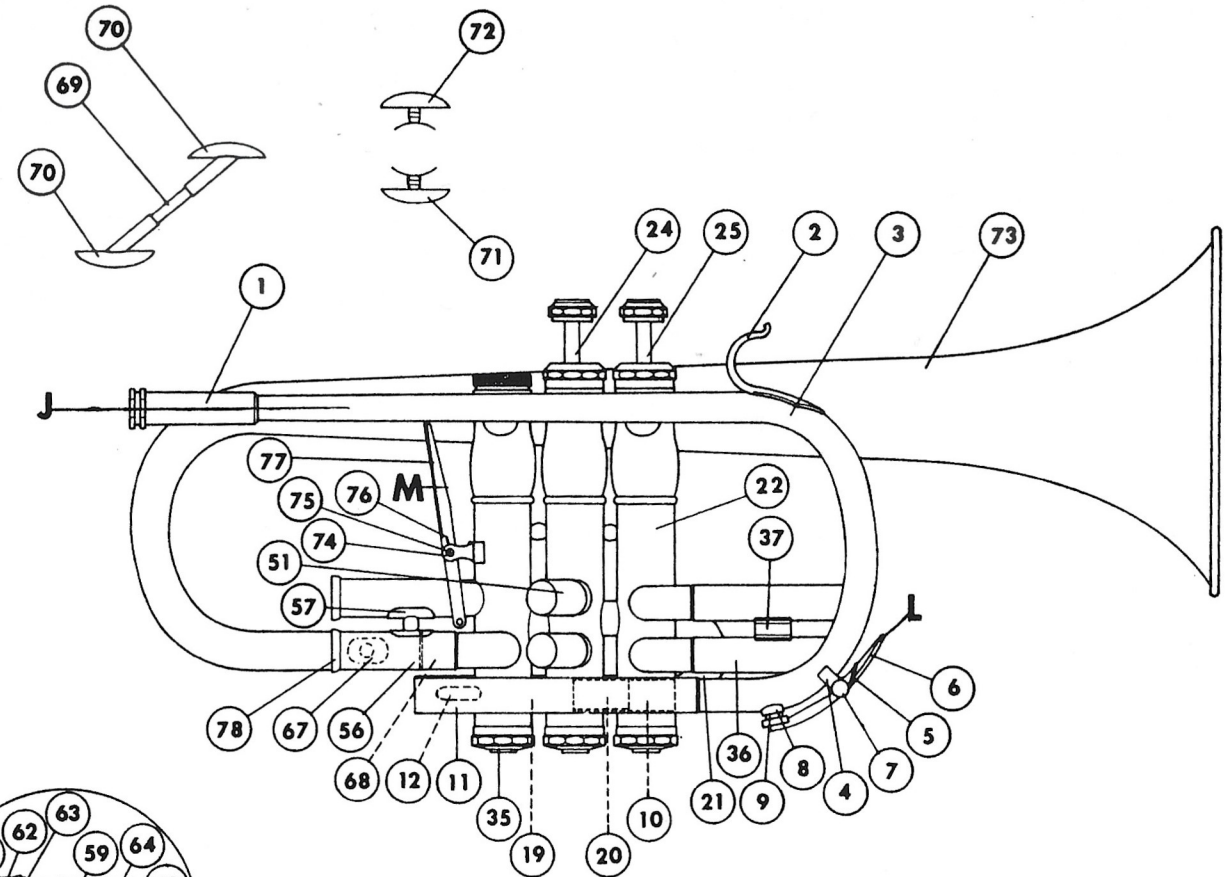
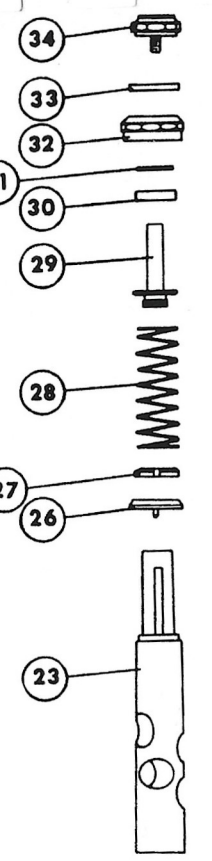

4210 T-5 STUDIO CORNET